

LICENCE & SAFETY PLAN

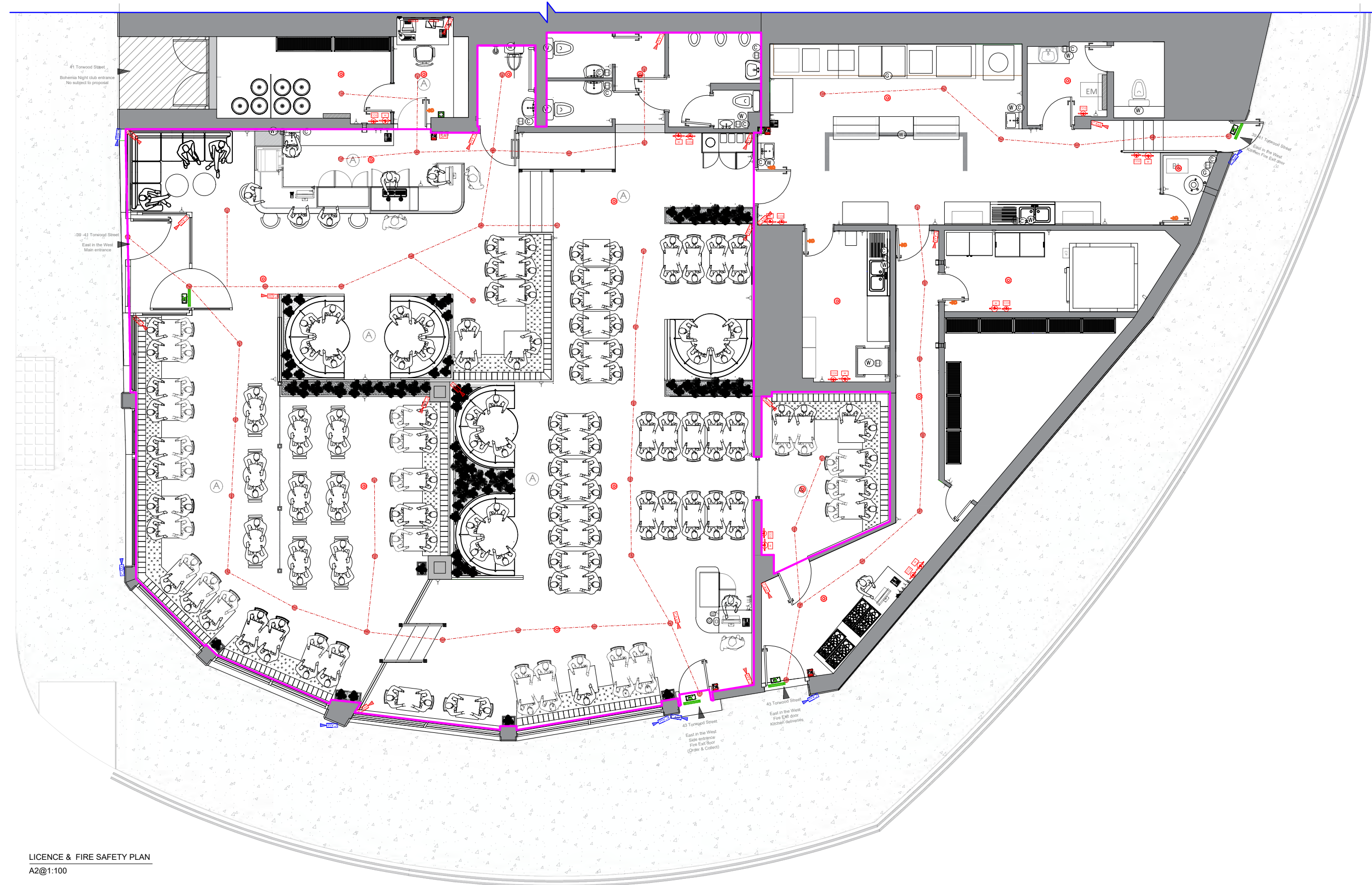

LEGEND:

	SINGLE SWITCHED WALL SOCKET		TV AERIAL POINT
	DOUBLE SWITCHED WALL SOCKET		IMMERSION HEATER AND THERMOSTAT
	SINGLE SWITCHED WALL SOCKET 1200MM ABOVE FLOOR LEVEL		MECHANICAL EXTRACT FAN
	DOUBLE SWITCHED WALL SOCKET 1200MM ABOVE FLOOR LEVEL		DOOR BELL PUSH
	SINGLE SWITCHED FUSE SPUR BELOW WORKTOP LEVEL		DOOR BELL CHIME
	FUSE SPUR FOR TOWEL RAIL		THERMOSTAT
	SINGLE SWITCHED FUSE SPUR AT HIGH LEVEL FOR EXTRACT FAN		SECURITY ALARM
	DOUBLE SWITCHED FLOOR SOCKETS		CONSUMER UNIT
	1 GANG LIGHT SWITCH		TELEPHONE POINT
	2 GANG LIGHT SWITCH		CAT 5 or 6 DATA SOCKET
	3 GANG LIGHT SWITCH		COOKER SWITCH
	1 GANG 2 WAY LIGHT SWITCH		MECHANICAL EXTRACT FAN COOKER HOB HOOD
	2 GANG 2 WAY LIGHT SWITCH		COMBINED HEAT DETECTOR AND FIRE ALARM SOUNDER
	1 GANG 3 WAY LIGHT SWITCH		COMBINED SMOKE/HEAT DETECTOR AND FIRE ALARM SOUNDER
	2 GANG 3 WAY LIGHT SWITCH		AUDIO SPEAKER
	1 GANG PULL CORD LIGHT SWITCH		RADIATOR
	EXTERNAL LIGHT		CAT 5E
	EXTERNAL LIGHT - BULKHEAD TYPE		2 CORE SPEAKER CABLE
	RECESSED DOWNLIGHTER		UNDERFLOOR HEATING MANIFOLD
	WALL LIGHT		
	LIGHT POINT - PENDANT HOLDER (4 INCH)		
	LIGHT POINT - PENDANT HOLDER (6 INCH)		
	LIGHT POINT - BATTEN HOLDER		

- General notes:
1. Technical specifications or specific instructions on drawings take precedence over these notes.
 2. Scaling permitted for planning purposes only.
 3. Unless noted otherwise, all dimensions are in millimetres (mm) and all levels are in metres (m).
 4. Details dimensions and levels to be checked on site by the contractor prior to commencement of works. Any works commenced prior to all necessary local authority approvals are entirely at the risk of the owner and contractor.
 5. Set out dimensions and levels shown on the drawings shall be verified by the contractor and refer to architectural drawings. The engineer shall be notified of any discrepancies prior to construction.
 6. Structural details are subject to exposure of existing construction and verification by Local Authority Surveyor (LAS) and any necessary revised details are to be agreed with the LAS prior to carrying out the affected works.
 7. All materials are to be used in accordance with the manufacturers' guidelines and all relevant British Standards Codes of Practice & Regulation 7 of Building Regs.
 8. All works are to be carried out in accordance with Local Authority requirements.
 9. The intended works fall within the Party Wall Act 1996 and any adjoining owners affected must be notified prior to commencement of any works.



Eagle House 163 City Road, London, EC1V 1NR

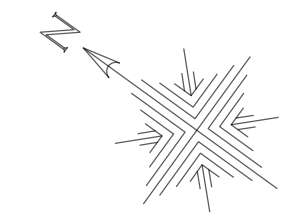

Job:
East in the West

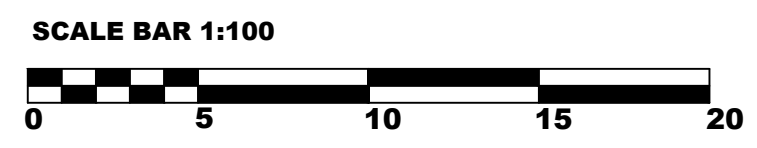

Address:
39-41 Torwood Street - TORQUAY - TQ1 1DZ

Client:
Mr Dinesh - Mr Ramesh Nair

Title:
Licence & Safety plan

Stage:
Proposal

Org No: 2	Amd - Vrs: 1	Drawn by: CEDRIC MAUCOURANT
Scale: 1:100 @ A1	MARCH 2023	

GENERAL NOTES:
Drawings To Be Read In Conjunction With Relevant Drawing And Specs.
Contractor To Check Site Thoroughly & Report Any Discrepancies.
Any Discrepancies Are To Be Pointed To The Agent.
No Responsibility Will Be Taken For Works Which Are Unforeseen And For Any Subsequent Alterations Made Which Are Beyond The Control Of The Agent.
This Drawing Shall Not Be Used For Building Regulations And / Or Construction Purposes.

General Notes:

- 1- It is the contractors responsibility to ensure that design principles, calculations, drawings and final construction must conform to the current building regulations, the cdm regulations, the relevant british or european codes of practice as appropriate.
- 2- Contractor must verify all site dimensions, drawings, details and specifications and report any discrepancies to client and/or designer before proceeding with any work.
- 3- All requested drawings showing fixings and construction details are required to be approved by client and/or designer prior to commencement of work.
- 4- All specified items are to be installed in accordance with the manufacturers recommendations.
- 5- Any dimensions are to be taken from the setting out plan only and are not to be scaled from the drawings.
- 6- The contractor is to check and appraise all design shop fitting and construction details and offer alternatives to client and/or designer for approval.
- 7- This drawing is to be read in conjunction with the other relevant, specification clauses, existing and consultants drawings (if applicable).

- 8- Unless noted otherwise, all dimensions are in Millimetres (mm) and all levels are in metres (m).
- 9- Details dimensions and levels to be checked on site by the contractor prior to commencement of works. Any works commenced prior to all necessary local authority approvals are entirely at the risk of the owner and contractor
- 10- Structural details are subject to exposure of existing construction (LAS) and verification by Local Authority Surveyor and any necessary (LAS) revised details are to be agreed with the LAS prior to carrying out the affected works.
- 11- All materials are to be used in accordance with the manufacturers' guidelines and all relevant British Standards Codes of Practice & Regulation 7 of Building Regs.

EMERGENCY FEATURES:
Contractor to make sure existing and new Emergency feature (Alarm control Panel, Emergency lighting, smoke detectors) is for purpose.

ELECTRICAL WORK:
To ensure electrical safety, floor plan has to be checked by electrician on site

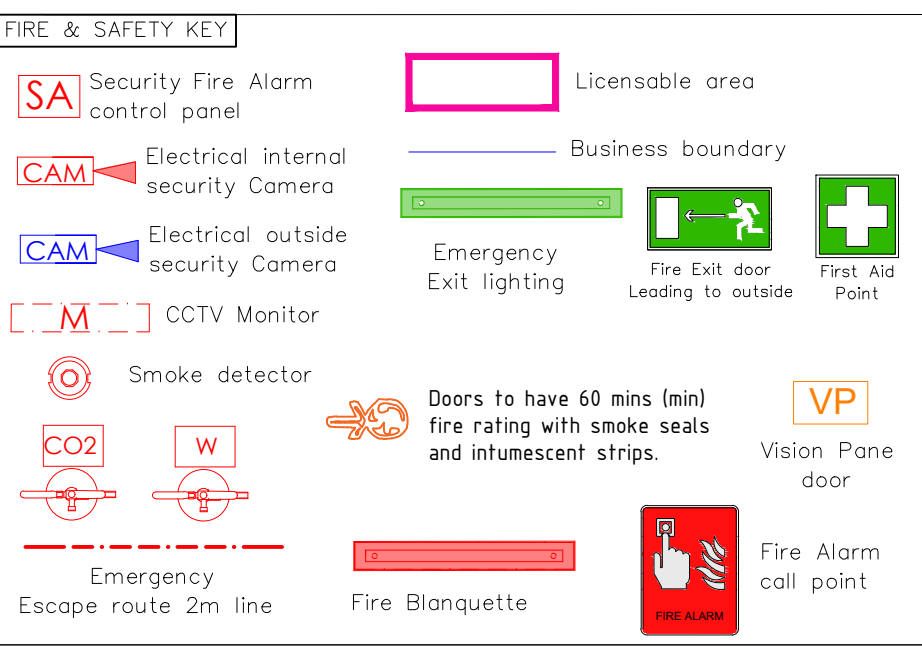

FIRE PRECAUTIONS

This drawing is indicative only. Refer to specialist Electrical Sub-contractors drawings and specifications for full details of fire alarm system and protect on.

All fire rated doors to be constructed in accordance with BS 476: Part 22 (or the British Standard in force when the door was manufactured).

All fire doors and final exit doors through which a person may have to pass on their way out of the premises in case of fire should be so fastened and maintained that they can be easily and immediately opened from the inside without the use of the key.

Exits other than those in normal use for egress should be marked and readily visible so that the occupants of the building can clearly and readily see where the exits are end where to go in an emergency at any time. Fire safety signs and notices to comply with the relevant requirements of BS 5499 : Part 1 - 1990.

ONE HOUR FIRE PROTECTION MUST BE PROVIDED TO COMPLY WITH BUILDING CONTROL